

1. Calculate the perimeter of the shape below.

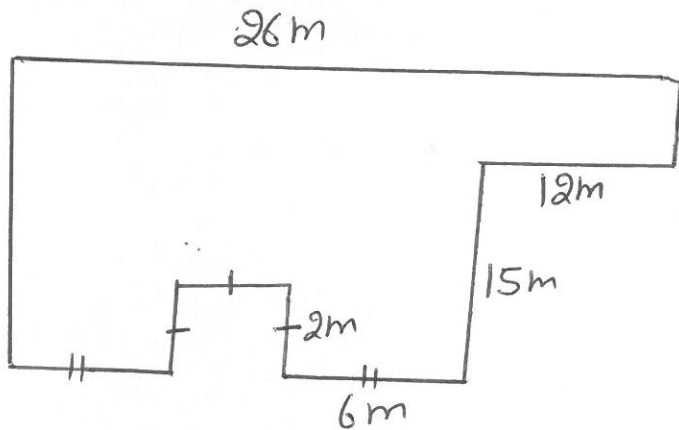

$$P =$$

7. Write in index form

$$3 \times 3 \times 3 \times 3 \times 3 =$$

8. Write in expanded form

$$5^3 =$$

9. $217.2 \div 6 =$

2. $12a - 18a =$

3. $36x \div 6 =$

4. $-7(x-3)$

5. $4.67 + 3.081 + 7.4 =$

6. 80% of 50

10.

$$0.2 \times 1.3 =$$

11.

$$\frac{8}{9} \times \frac{3}{16} =$$

12. If $a=5$ and $b=3$

$$a+b =$$